



# 1500 Vinyl Collection

Single Hung Windows

BUILDER



Building choice into every view.



# 1500 Single Hung Windows



## Upgrade your view

- High performance in a builder's window
- Traditional or contemporary frame design
- SDL or GBG grilles
- Sizes to meet your need
- Egress Size: 3050SH, 4040SL
- Limited Lifetime Warranty

When you build a lot of homes, you expect a lot from your windows. Quality. Performance. Value. A company you can count on. Our new 1500 vinyl windows offer all that and more, including a full range of options to meet your every need.

## Color options

\*New exterior colors are on brickmould and flat casing only.



## Frame Options



Brickmould

Beveled

Flat

## Window Anatomy

Multi-chamber construction with fusion-welded sash and frame

7/8" or 1" dual or triple pane insulated glass with Warm Edge spacer saves energy

Sloped sill drains water away from home exterior

Integral J-channel for simple, secure siding installation (optional double utility trim)



## Grille types

\*Also available with no grilles.

### GBG Grilles



3/4" Flat, 5/8" or 1" Sculptured

### SDL Grilles



7/8" or 1-1/4" SDL with Shadow Bar

## Glass options

Compare U-Factor ratings

Visit [1500vinylcollection.com](http://1500vinylcollection.com) for more detailed information

### Low-E

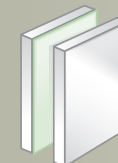

7/8" Low-E	.35	SHGC .29
One lite of Low-E		
7/8" Low-E <sup>SC</sup>	.35	SHGC .22
One lite of solar cooling Low-E		
7/8" Low-E2+	.30	SHGC .28
One lite of Low-E and one lite of Interior Surface Low-E		

### Low-E with Argon

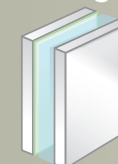

7/8" HP	.32	SHGC .28
One lite of Low-E with argon		
7/8" HP <sup>SC</sup>	.32	SHGC .22
One lite of solar cooling Low-E with argon		
7/8" HP2+	.28	SHGC .28
One lite of Low-E and one lite of Interior Surface Low-E with argon		

### Triple-Glazed



7/8" HP2 <sub>Max</sub>	.25	SHGC .25
Two lites of Low-E with two chambers of argon		
7/8" HP3 <sub>Max</sub>	.23	SHGC .22
Two lites of Low-E, two chambers of argon, one lite of Interior Surface Low-E		
1" HP3 <sub>Max</sub>	.22	SHGC .22
Two lites of Low-E, two chambers of argon, one lite of Interior Surface Low-E		

Values reflect 3050 call size brickmould non-drywall glazed single window with 3mm glass, no grilles.



# easyinstall

for a quick, correct fit

- Alignment clips
- Integral mull
- Removable meeting rail
- Double utility trim
- Integral J-channel or flange
- Drywall receiver and return
- Accessory grooves
- Protective construction film



Scan with your smartphone for product performance data.  
1500VinylCollection.com



## Window Highlights



Optional H-LC 50 Upgrade in Limited Sizes



Interior

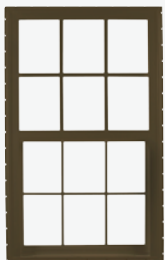

Exterior



### Jamb Alignment Clips

Aligns and holds frame in place during installation; enables one person to center smaller windows.



### Removable Meeting Rail

Patent pending meeting rail anchor makes removing rail simple; ideal for drywall applications.

Patent Pending number: 61746220



### Recessed Tilt-latch

Low profile design features a patent pending barrel tilt latch that locks under load.

Patent Pending number: 61746222



### Interlocking Sashes

Sashes lock tightly together to help keep out intruders and inclement weather.



### Forced Entry Resistant Locks

Enhanced security locks meet tough AAMA forced entry requirements. ADA and auto-lock options available.



ADA Lock



Auto Lock



Scan with your smartphone for performance data, window sizes, CAD drawings and more.  
1500VinylCollection.com



# Building choice into every view

## WindowSpecs

### FRAME

- 3 1/2" dual wall brickmould frame depth
- 2 7/8" beveled frame depth
- 1 3/8" integral nail fin set back
- Optional 1/2" flush flange for block installs
- Optional 3 1/2" flat casing
- Optional double utility trim simplifies siding installation
- Custom and traditional sizing to meet your needs
- Integral J-pocket simplifies siding installations
- Interior/exterior accessory grooves
- Sloped sill for water management
- Screen clip PP#: 61738783
- Mixed operating and fixed integral mulls PP#: 61820933

### SASH

- Interior glazed top glass
- Exterior glazed bottom glass
- Interlocking sash with dual pile weatherstripping
- Inverted block & tackle or constant force coil balances
- Recessed tilt-latch locks under load PP#: 61746222
- Dual lift rails for easy operation
- Easy to remove meeting rail PP#: 61746220
- Half screens (shipped separately or installed)

### GLASS

- Double: Low-E, Low-E<sup>SC</sup>, Low-E2+, Low-E2+<sup>SC</sup>, HP, HP<sup>SC</sup>, HP2+, HP2+<sup>SC</sup>
- Triple: HP2<sup>MAX</sup>, HP2<sup>MAX</sup><sup>SC</sup>, HP3<sup>MAX</sup>, HP3<sup>MAX</sup><sup>SC</sup>
- Optional Warm Edge+ spacers
- Configurable STC values up to 33
- Impact, tempered, obscure and rain options
- EZ Clean option

### GRILLES

- GBG (Grilles Between Glass) 3/4" Flat, 5/8" or 1" Sculptured
- SDL (Simulated Divided Lite) 7/8" or 1 1/4" with Shadow Bar
- Colonial, Plaza, Prairie, Diamond, Gothic patterns available

### LOCKS

- Standard forced entry resistant cam lock
- Self-latching forced entry resistant auto-lock option
- ADA forced entry resistant auto-lock option

### PERFORMANCE CERTIFICATIONS

- FLORIDA APPROVED FL16103  
For a list of Ply Gem's Florida approved products visit [floridabuilding.org](http://floridabuilding.org).
- CANADIAN STANDARDS ASSOCIATION CERTIFIED
- TEXAS DEPARTMENT OF INSURANCE  
WIN1769 non-impact, WIN1771 impact

1



Brickmould Beveled Flat

### Select a frame profile

We offer different profiles to complement different architectural styles.

2



### Select colors

We provide several color options to suit your home's unique style.

*(New exterior colors are on brickmould and flat casing only and are not available on beveled.)*

3

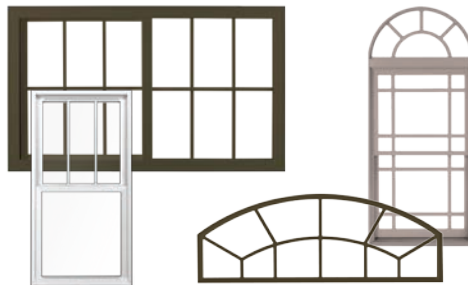

### Add character with grilles and shapes.

Choose from a variety of distinctive looks.

4



### Multiply the effect.

Combine fixed and operating windows to make a dramatic statement.

5

### Enjoy the view.



For more information, call 888-9PLYGEM.